

ABERNATHY and ASSOCIATES

Kenneth B. Abernathy Jr.

Wisconsin Registered Land Surveyor S-1594

Rt. 3, Box 273

Elkhorn, Wisconsin 53121

Phone: (414) 723-4260 (office)

(414) 723-4813 (residence)

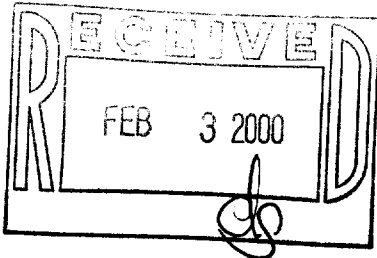

PLAT OF SURVEY

SOUTH SHORE DRIVE

S 88°33'00" E
89.95'

overhead utilities along this line

LINE	BEARING	DISTANCE
L1	S 4°50'00" E	15.00
L2	S 53°20'00" W	24.91

OWNERS: MATHIAS and ANN KLEIN
805 BERMUDA DRIVE
NORTHBROOK, IL. 60062

UNIT 44

UNIT 45

NOTE:

THIS FIRM WAS HIRED BY THE OWNERS TO LOCATE THE EXISTING EXTERIOR STAKES FOR THE SUBJECT UNIT. A PREVIOUS PLAT OF SURVEY PREPARED BY ROBERT H. BAERENWALD AND DATED APRIL 14, 1989 WAS SUPPLIED BY THE OWNERS TO ASSIST IN THIS SURVEY. THE IMPROVEMENTS SHOWN ON THE PREVIOUS SURVEY WERE NOT LOCATED BY AGREEMENT WITH THE OWNER.

UNIT 44 OF ABBEY SPRINGS
CONDOMINIUM NO. 1, LOCATED IN THE
VILLAGE OF FONTANA-ON GENEVA LAKE,
WALWORTH COUNTY, WISCONSIN.

ABBIE SPRINGS
CONDO NO. 2

Legend

- ⊗ FOUND IRON PIPE
- FOUND IRON ROD
- FOUND BRASS CAPPED MONUMENT
- ⊗ FOUND CONCRETE MONUMENT
- + CHISEL CUT IN CONCRETE
- SET IRON ROD, 24" LONG, WEIGHING 1.5 LBS./LINEAL FT., 3/4" DIA.
- SET IRON ROD, 30" LONG, WEIGHING 4.5 LBS./LINEAL FT., 1-11/16" DIA.
- (xx) RECORDED AS DIMENSION
- x-x- EXISTING FENCE

ROLLING GREEN DRIVE

SCALE: 1" = 30 FEET

"I hereby certify that I have surveyed the above described property and that the above map is a true representation thereof and shows the size and location of the property, its exterior boundaries, the location of all visible structures and dimensions of all principal buildings thereon, boundary fences, apparent easements, roadways and visible encroachments, if any."

"This survey is made for the use of the present owners of the property, and also those who purchase, mortgage, or guarantee the title thereto within one year from date hereof."

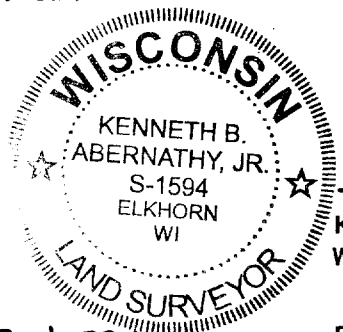

KENNETH B. ABERNATHY, JR.
WISCONSIN REGISTERED LAND SURVEYOR,
S-1594

Date: NOVEMBER 10, 1999 Job No. 99.1105

SCDB-44

005-1781